



IS



MATERIALI PRIVI DI ALOGENI
HALOGEN FREE

PORTASBARRE ISOLANTI A PETTINE
INSULATING BUS-BAR SUPPORTS

| Tipo/Type | Dimens. | | | | | D - N° |
|-----------|---------|----|----|------|---|--------|
| | A | B | C | D | | |
| IS001 | 68 | 32 | 52 | 5,3 | 4 | |
| IS004 | 77 | 32 | 52 | 10,3 | 3 | |
| IS007 | 52 | 32 | 52 | 10,3 | 2 | |

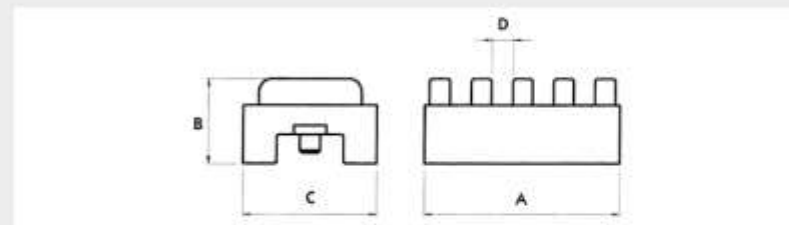

PROFILATO PER PORTASBARRE
SUPPORTING IRON CHANNEL

| Tipo/Type |
|-----------|
| IS101 |

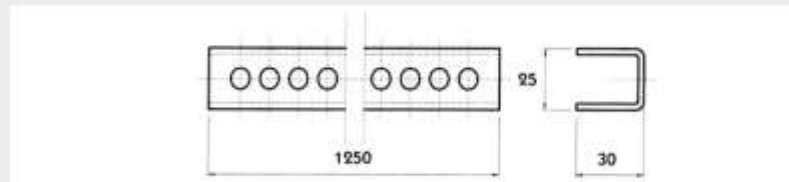

MATERIALI PRIVI DI ALOGENI
HALOGEN FREE

PERNO DI BLOCCAGGIO
LOCKING PIN

| Tipo/Type | Conf. pezzi/Pack pieces |
|-----------|-------------------------|
| IS401 | 50 |

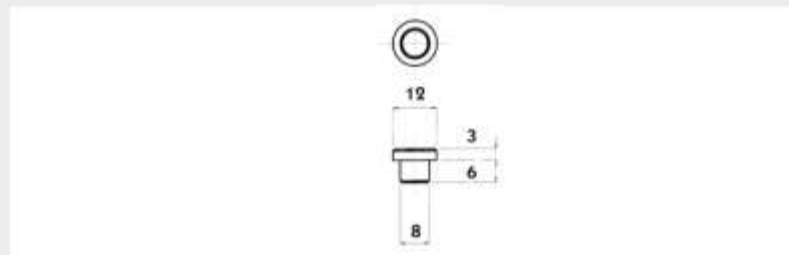



Portasbarre a pettine

Bus-bar supports

IS

MATERIALI PRIVI DI ALOGENI
HALOGEN FREE

CARATTERISTICHE TECNICHE/FEATURES

| Dimens. Sbarra Bar dimensions | | N. sbarre per fase - N. of bars per phase | | | | | | | | | | | |
|--|----|---|----|--|-----|------------------------|---------|--|-----|------------------------|-----|--|----------|
| | | 1 | | 2 | | 3 | | 4 | | 1 | | 2 | |
| | | Interasse Clearance | | Materiale tirante Material tension rod | | Interasse Clearance | | Materiale tirante Material tension rod | | Interasse Clearance | | Materiale tirante Material tension rod | |
| C | D | A | B | A | B | A | B | A | B | A | B | A | B |
| 50 | 5 | 91 | 78 | Fe/Iron | 91 | 78 | Fe/Iron | 104 | 91 | Ot/Brass | 117 | 104 | Ot/Brass |
| | 6 | 91 | 78 | Fe/Iron | 91 | 78 | Fe/Iron | 104 | 91 | Ot/Brass | 130 | 104 | Ot/Brass |
| | 8 | 91 | 78 | Fe/Iron | 91 | 78 | Fe/Iron | 130 | 104 | Ot/Brass | 156 | 117 | Ot/Brass |
| | 10 | 91 | 78 | Fe/Iron | 104 | 91 | Fe/Iron | 143 | 104 | Ot/Brass | 156 | 117 | Ot/Brass |
| 60 | 5 | 91 | 78 | Fe/Iron | 91 | 78 | Fe/Iron | 104 | 91 | Ot/Brass | 117 | 104 | Ot/Brass |
| | 6 | 91 | 78 | Fe/Iron | 91 | 78 | Fe/Iron | 104 | 91 | Ot/Brass | 130 | 104 | Ot/Brass |
| | 8 | 91 | 78 | Fe/Iron | 91 | 78 | Fe/Iron | 130 | 104 | Ot/Brass | 156 | 117 | Ot/Brass |
| | 10 | 91 | 78 | Fe/Iron | 104 | 91 | Fe/Iron | 143 | 104 | Ot/Brass | 156 | 117 | Ot/Brass |
| 80 | 5 | 91 | 78 | Fe/Iron | 91 | 78 | Fe/Iron | 104 | 91 | Ot/Brass | 117 | 104 | Ot/Brass |
| | 6 | 91 | 78 | Fe/Iron | 91 | 78 | Fe/Iron | 104 | 91 | Ot/Brass | 130 | 104 | Ot/Brass |
| | 8 | 91 | 78 | Fe/Iron | 91 | 78 | Fe/Iron | 130 | 104 | Ot/Brass | 156 | 117 | Ot/Brass |
| | 10 | 91 | 78 | Fe/Iron | 104 | 91 | Fe/Iron | 143 | 104 | Ot/Brass | 156 | 117 | Ot/Brass |
| 100 | 5 | 91 | 78 | Fe/Iron | 91 | 78 | Fe/Iron | 104 | 91 | Ot/Brass | 117 | 104 | Ot/Brass |
| | 6 | 91 | 78 | Fe/Iron | 91 | 78 | Fe/Iron | 104 | 91 | Ot/Brass | 130 | 104 | Ot/Brass |
| | 8 | 91 | 78 | Fe/Iron | 91 | 78 | Fe/Iron | 130 | 104 | Ot/Brass | 156 | 117 | Ot/Brass |
| | 10 | 91 | 78 | Fe/Iron | 104 | 91 | Fe/Iron | 143 | 104 | Ot/Brass | 156 | 117 | Ot/Brass |
| 120 | 5 | 91 | 78 | Fe/Iron | 91 | 78 | Fe/Iron | 104 | 91 | Ot/Brass | 117 | 104 | Ot/Brass |
| | 6 | 91 | 78 | Fe/Iron | 91 | 78 | Fe/Iron | 104 | 91 | Ot/Brass | 130 | 104 | Ot/Brass |
| | 8 | 91 | 78 | Fe/Iron | 91 | 78 | Fe/Iron | 130 | 104 | Ot/Brass | 156 | 117 | Ot/Brass |
| | 10 | 91 | 78 | Fe/Iron | 104 | 91 | Fe/Iron | 143 | 104 | Ot/Brass | 156 | 117 | Ot/Brass |

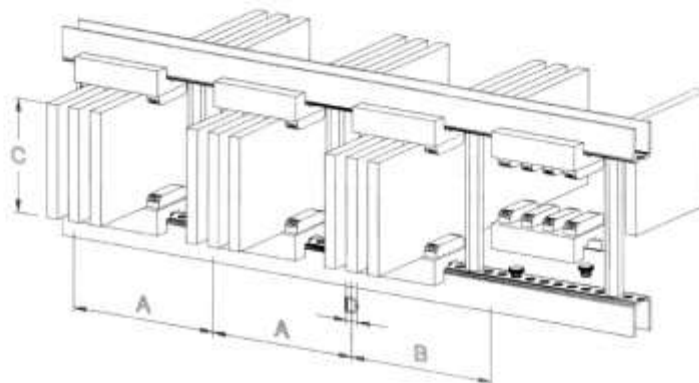



Portasbarre a pettine

Bus-bar supports

IS



ISOLATORI E ACCESSORI DI CABLAGGIO

DETERMINAZIONE DELLA DISTANZA "S" TRA I SUPPORTI IN FUNZIONE DELLA DISTANZA "A" FRA LE FASI E DELLE CORRENTI DI CORTO CIRCUITO
DISTANCE "S" DETERMINATION BETWEEN SUPPORTS CONSIDERING DISTANCE "A" BETWEEN PHASES AND THE SHORT-CIRCUIT.

| A | CORRENTI DI CORTO CIRCUITO EFFICACE/R.M.S. SHORT-CIRCUIT | | | | | | |
|-----|--|-----|-----|-----|-----|-----|-----|
| | 30 | 40 | 50 | 60 | 70 | 80 | 100 |
| 91 | 700 | 530 | 500 | | | | |
| 104 | 800 | 550 | 520 | 490 | 400 | | |
| 117 | | 600 | 530 | 500 | 450 | 370 | |
| 130 | | 650 | 540 | 510 | 480 | 400 | 280 |
| 143 | | 700 | 550 | 520 | 500 | 430 | 310 |
| 156 | | | | | | 450 | 340 |

Tutte le quote sono espresse in millimetri.

All the measures are expressed in millimetres.

La presente tabella è stata determinata prevedendo l'impiego del perno di bloccaggio tipo "IS 401"

The table has been made considering the use of the locking pin type "IS 401"

